

Installing the ceramic element in a PAS heater

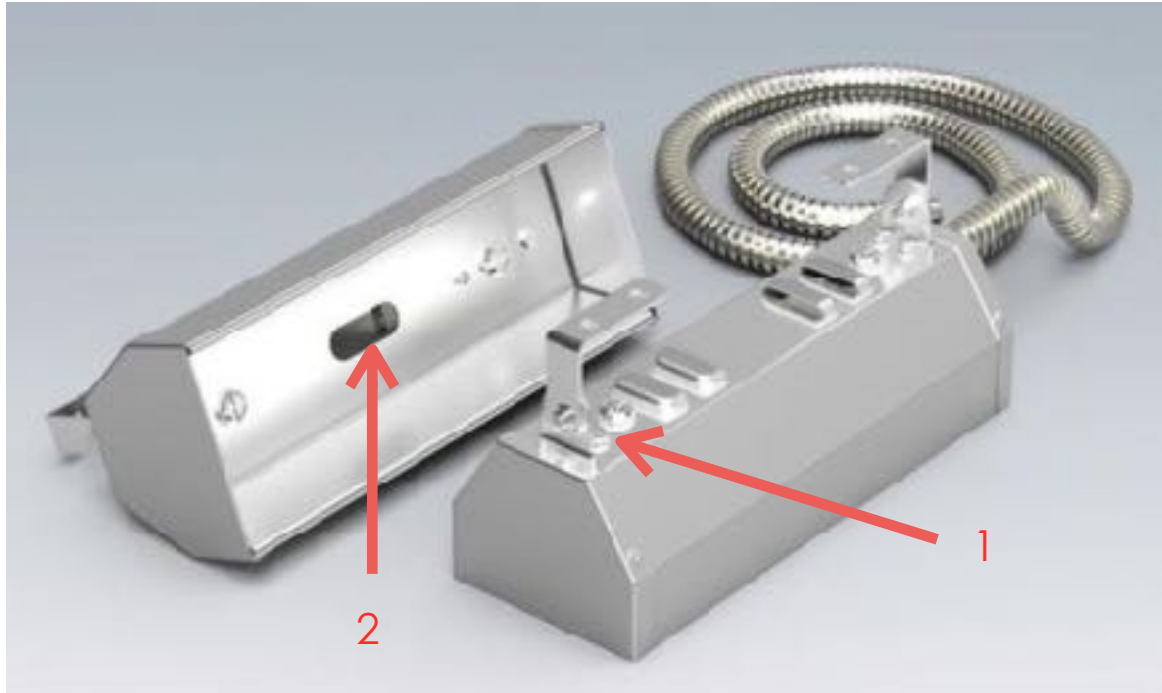

1. Remove heater from packaging
2. Remove 2 screws location at the back **(no1)**
3. Remove reflector from heater body while feeding high heat wires through metal tube
4. Remove protective blue film from reflector
5. Fit Ceramic element through slots in reflector en secure with the clips at the back

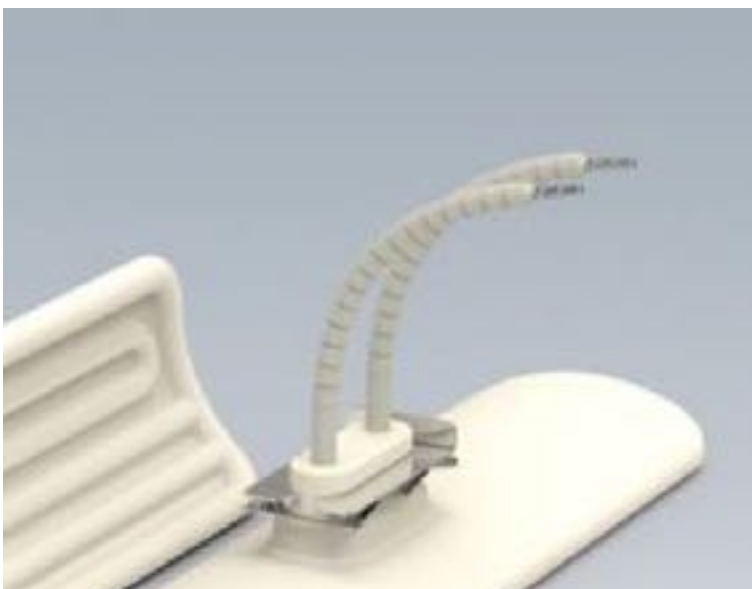

6. Connect each beaded wire from the element to each pole of the ceramic connector block
7. For detailed instructions look at the following video:

<https://youtu.be/J6Zku0rjaXU>

8. For multiple elements link them in parallel



9. Remove protective blue film from heater

10. Re-assemble heater and connect

### Connecting an Element with a thermal control

The 2 centre beaded wires must be connected to the Temperature controls using heat resistance wire

